



PRODUCT DESCRIPTION

Dramatic and opulent, light sources shine through exquisite Clear scalloped glass hurricane shades as they seemingly float on unique metal prongs finished in Antique Brass. The brass accents are contrasted with a Black frame configured in cascading pendant forms, classically tiered chandeliers and elongated individual pendants. The expansive variety of configurations present a configuration for all the interior spaces of a home, be it over dining tables or used in the entry, kitchen, or over the vanity. The collection also includes ADA wall sconces that are left and right oriented for symmetrical installations bedside or beside a mirror.

FINISHES OPTION

Black / Antique Brass (BKAB)

GLASS
Clear CL

MATERIAL
Glass, Steel

RATINGS
cETLus
Dry Location



ADDITIONAL
SLOPE: 90
RATED LIFE 35000 Hours
OPERATING TEMPERATURE:
-20°C (-4°F), 40°C (104°F)

MEASUREMENTS

DIMENSION : 33" L x 33" W x 14" H
 MAX OAH : 54.75" OAH
 CANOPY : 5" W x 0.75" H x 5" L
 HANGING WEIGHT : 12.98 lb

LAMPING

INPUT VOLTAGE : 120-277V
 LUMENS : 920 Rated
 BULB : 1.8W LED 12V G4 , 14W Total
 BULB INCLUDED : (Included)
 DIMMABLE : ELV at 120V, 0-10V
 CRI : 90 CRI
 COLOR_TEMP : 3000K

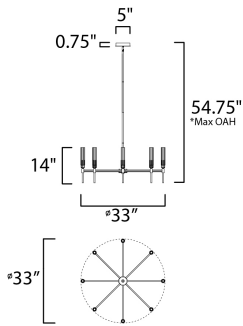

*max overall height

Always consult a qualified electrician before installing any lighting product.



Modifications or Customizations: Please email contract@studiomlighting.com
Sample Request: Please email order@studiomlighting.com with subject line
 "Sample Order_ [Project Name] / [Specifier/Designer]"
 All samples are subject to Studio M approval and must show proof of project and/or explanation.

Job Name:	Job Type:
Quantity:	Comments: