



**PRODUCT DESCRIPTION**

Constructed of double thick aluminum which has a hammered interior finish polished so to not only be beautiful but multiply the lumen output. High polish enamel paints finish the exterior for the ultimate reflective surface. The larger sizes are fitted with commercial grade LED and multi-volt input drivers that dim with both ELV and 0-10V functions.

**FINISHES OPTION**

-  Gloss Black / Aluminum (GBAL)
-  Gloss Black / Gold (GBGLD)
-  Gloss Navy / Aluminum (GNAL)
-  Gloss Taupe / Aluminum (GTAL)
-  Gloss White / Aluminum (GWAL)

**MATERIAL**

Aluminum

**RATINGS**

cETLus  
Dry Location



**ADDITIONAL**

SLOPE: 30  
RATED LIFE 25000 Hours  
OPERATING TEMPERATURE:  
-20°C (-4°F), 40°C (104°F)

**MEASUREMENTS**

DIMENSION : 31" L x 31" W x 17" H  
MAX OAH : 136" OAH  
CANOPY : 6" W x 1" H x 6" L  
HANGING WEIGHT : 12.3 lb

**LAMPING**

INPUT VOLTAGE : 120-277V  
LUMENS : 2,900 Rated (1,440 Del.)  
BULB : 30W LED PCB Integrated , 30W Total  
BULB INCLUDED : (Integrated)  
DIMMABLE : Triac, ELV, 0-10V  
CRI : 90 CRI  
COLOR\_TEMP : 3000K

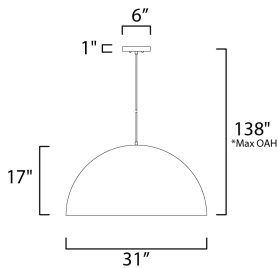

\*max overall height

Always consult a qualified electrician before installing any lighting product.

**STUDIO•M**

**Modifications or Customizations:** Please email [contract@studiomlighting.com](mailto:contract@studiomlighting.com)  
**Sample Request:** Please email [order@studiomlighting.com](mailto:order@studiomlighting.com) with subject line "Sample Order\_ [Project Name] / [Specifier/Designer]"  
All samples are subject to Studio M approval and must show proof of project and/or explanation.

Job Name:	Job Type:
Quantity:	Comments: