

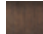



**PRODUCT DESCRIPTION**

Hand-woven Natural Rattan blends casual comfort with impeccable craftsmanship. Further demonstrating the artisanal touch applied to this series, two hand-painted finish options either match Weathered White on both the rattan and its metal work or contrast Natural tones with an Antique Bronze finish. Choose from various scales of pendants where in some configurations a Satin White globe shade is included to diffuse the light source within. An ADA wall sconce completes the collection.

**FINISHES OPTION**

-  Antique Bronze (ANB)
-  Weathered White (WWT)

**MATERIAL**

Steel, Rattan

**RATINGS**

cULus  
Dry Location



**ADDITIONAL**

OPERATING TEMPERATURE:  
-20°C (-4°F), 40°C (104°F)

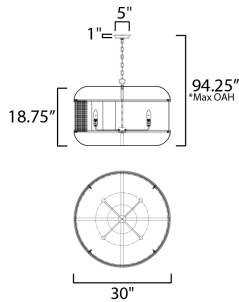

**MEASUREMENTS**

- DIMENSION : 30" L x 30" W x 18.75" H
- MAX OAH : 94.25" OAH
- CANOPY : 5" W x 1" H x 5" L
- HANGING WEIGHT : 16.06 lb

**LAMPING**

- INPUT VOLTAGE : 120V
- BULB : 60W Incandescent E12 Candelabra , 300W Total
- BULB INCLUDED : (Not Included)
- DIMMABLE : Triac or ELV

\*max overall height

Always consult a qualified electrician before installing any lighting product.

**STUDIO•M**

**Modifications or Customizations:** Please email [contract@studiomlighting.com](mailto:contract@studiomlighting.com)  
**Sample Request:** Please email [order@studiomlight.com](mailto:order@studiomlight.com) with subject line "Sample Order\_ [Project Name] / [Specifier/Designer]"  
 All samples are subject to Studio M approval and must show proof of project and/or explanation.

Job Name:	Job Type:
Quantity:	Comments: