



**MAT SANDERS**  
STUDIO•M

**PRODUCT DESCRIPTION**

Ominous glows of LED illuminated glass spheres appear behind glass shades that are opaque when not lit. These deformed sphere shapes of glass are purposely oblong and available in either Mirror plated glass or etched Satin White. They are paired with metalwork in Gunmetal or Natural Aged Brass and include lighting that can be mounted as wall sconces or ceiling lights with additional pendant options that feature a filigree cap perforated with retro dot cut-outs.

**MEASUREMENTS**



DIMENSION : 14" L x 14" W x 10.5" H  
 CANOPY : 5" W x 1" H x 5" L  
 HANGING WEIGHT : 5.07 lb

**LAMPING**

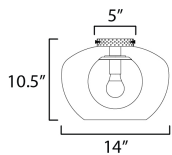
BULB : 9W LED E26 Medium , 9W Total  
 BULB INCLUDED : (Included)  
 CRI : 90 CRI  
 COLOR\_TEMP : 3000K



**FINISHES OPTION**

-  Gunmetal (GM)
-  Heritage (HR)
-  Polished Chrome (PC)

**GLASS**

Mirror Smoke MSK

**MATERIAL**

Steel, Glass

**RATINGS**

cETLus  
 Damp Location



**ADDITIONAL**

RATED LIFE 25000 Hours  
 OPERATING TEMPERATURE:  
 -20°C (-4°F), 40°C (104°F)

Always consult a qualified electrician before installing any lighting product.

**STUDIO•M**

**Modifications or Customizations:** Please email [contract@studiomlighting.com](mailto:contract@studiomlighting.com)  
**Sample Request:** Please email [order@studiomlighting.com](mailto:order@studiomlighting.com) with subject line "Sample Order\_ [Project Name] / [Specifier/Designer]"  
 All samples are subject to Studio M approval and must show proof of project and/or explanation.

|           |           |
|-----------|-----------|
| Job Name: | Job Type: |
| Quantity: | Comments: |