



PRODUCT DESCRIPTION

A contemporary design featuring a Satin Nickel frame supporting Clear cylinder glass shades with Frost interior diffusers all powered with energy efficient LED technology. Finally LED technology at an affordable price.

MEASUREMENTS

DIMENSION : 14.25" W x 6.75" H x 7.75" Ext
 BACK PLATE : 5" W x 2" H x 4.5" HCO
 HANGING WEIGHT : 3.53 lb

LAMPING

INPUT VOLTAGE : 120V
 LUMENS : 1,300 Rated (1,100 Del.)
 BULB : 7.5W LED PCB Integrated , 15W Total
 BULB INCLUDED : (Integrated)
 DIMMABLE : Triac CL
 CRI : 90+ CRI
 COLOR_TEMP : 3000K

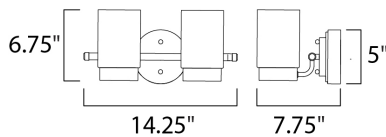

FINISHES OPTION

 Satin Nickel (SN)

GLASS

Clear and Frosted CLFT

MATERIAL

Steel, Glass

RATINGS

cETLus
 Damp Location



ADDITIONAL

INSTALL UP/DOWN: UP
 OPERATING TEMPERATURE:
 -20°C (-4°F), 40°C (104°F)

Always consult a qualified electrician before installing any lighting product.



Modifications or Customizations: Please email contract@studiomlighting.com
Sample Request: Please email order@studiomlighting.com with subject line "Sample Order_ [Project Name] / [Specifier/Designer]"
 All samples are subject to Studio M approval and must show proof of project and/or explanation.

Job Name:	Job Type:
Quantity:	Comments: